

CENTRAL OREGON SPORTSMEN'S SHOW

MARCH 7 – 10, 2024

DESCHUTES COUNTY FAIR & EXPO CENTER

BOOTH SPACE BULK SPACE

\$900 US per 10'x10' Booth

Booths 327-332 & 366-371 5' x 20'

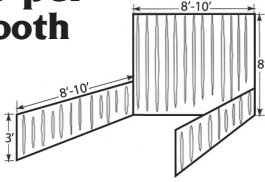

Indoor **\$2.00 US per Sq. Ft.**
Outdoor **\$1.25 US per Sq. Ft.**

No drapes/space dividers furnished with bulk space.
Electrical—first 1000 \square gets one 5 amp outlet; each additional 750 \square receives another 5 amp outlet, indoor or outdoor bulk space.

Each Exhibiting Company is furnished with 8' backwall drapes and 3' sidewall drapes and one 5 amp electrical outlet at no extra charge.

EXHIBIT HOURS

Subject to change

Thurs., Mar. 7 12 nn to 8 pm
Fri., Mar. 8 12 nn to 8 pm
Sat., Mar. 9 10 am to 8 pm
Sun., Mar. 10 10 am to 4 pm

We only accept payment by

CASH CHECK ACH WIRE

There will be a \$50 charge for any check/ACH returned.



Hurry, because space at the Central Oregon Sportsmen's Show sells out early! This show is enormously popular because of the runaway buying that occurs every year at this event. Crowds come from southwest Washington, plus eastern and southern Oregon.



If your target is outdoor enthusiasts then the Central Oregon Sportsmen's Show is a perfect fit! Outdoor enthusiasts of all stripes come to this show to buy knowing this is the place to be to find the gear they're after.



Local, out-of-state and international guides, outfitters and safaris stay busy booking trips at the Central Oregon Sportsmen's Show. Business is brisk thanks to strict category caps that are in place to assure your success at the show.



Overlanding, boating, kayaking and RV's are all popular categories at the Central Oregon Sportsmen's Show. It's a great place to get a profitable conversation started!



The Central Oregon Sportsmen's Show is the largest sportsmen's show east of the Cascades and second-largest event in Deschutes County. When the gates open --- the crowds come to buy!

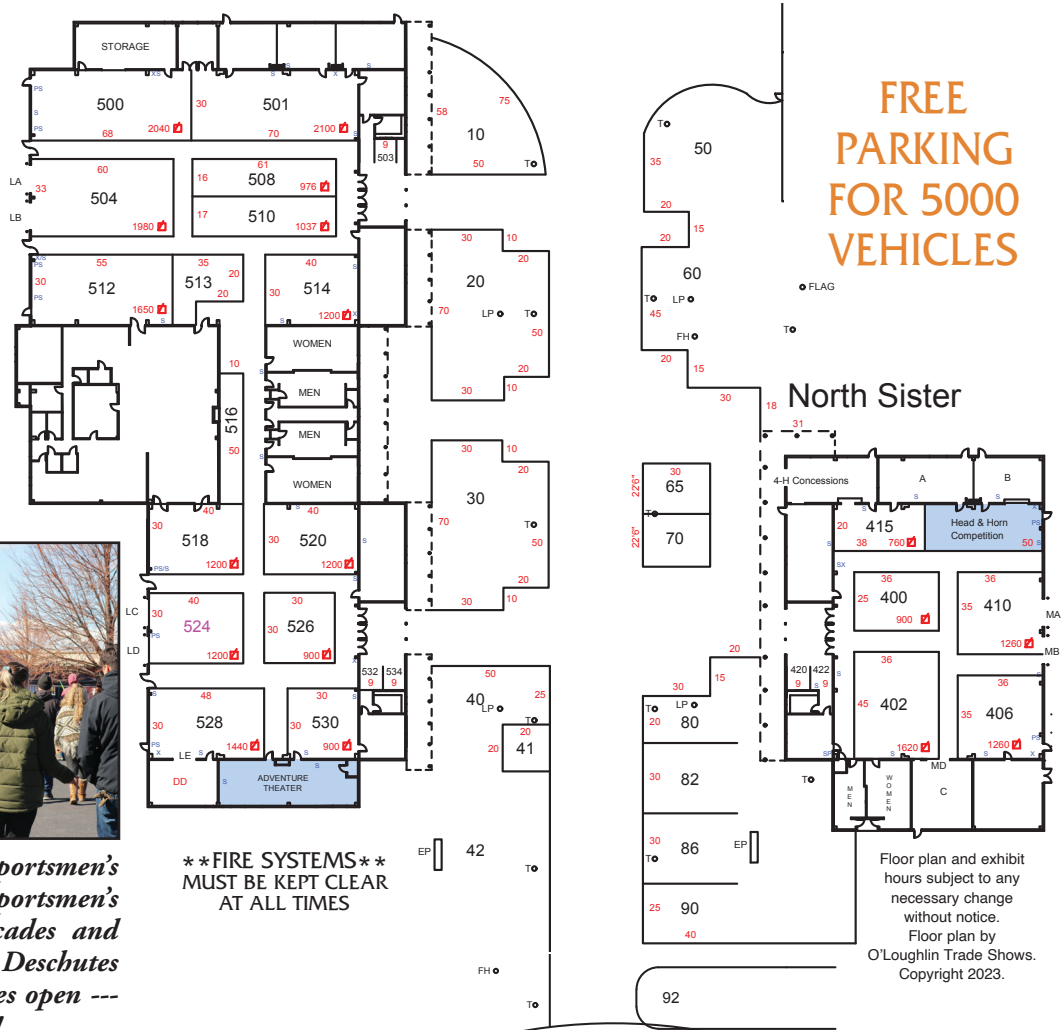

FREE PARKING FOR 5000 VEHICLES

North Sister

Floor plan and exhibit hours subject to any necessary change without notice.
Floor plan by O'Loughlin Trade Shows. Copyright 2023.

****FIRE SYSTEMS** MUST BE KEPT CLEAR AT ALL TIMES**

44

46

SYMBOLS

- D Drains
- WC Water (1-1/2")
- S Strobe Alarm
- X Fire Extinguisher
- PS Pull Station
- SP Stand Pipe
- EP Electrical Panel
- T Tree
- LP Light Pole

ROLL-UP DOORS

- | | |
|----------------|----------------|
| AA 14'H x 14'W | MA 14'H x 12'W |
| AB 11'H x 10'W | MB 14'H x 12'W |
| AC 11'H x 10'W | MC 7'H x 10'W |
| AD 9'H x 9'W | MD 7'H x 10'W |
| AE 14'H x 14'W | |
| LA 12'H x 12'W | |
| LB 12'H x 12'W | |
| LC 12'H x 12'W | |
| LD 12'H x 12'W | |
| LE 7'H x 10'W | |

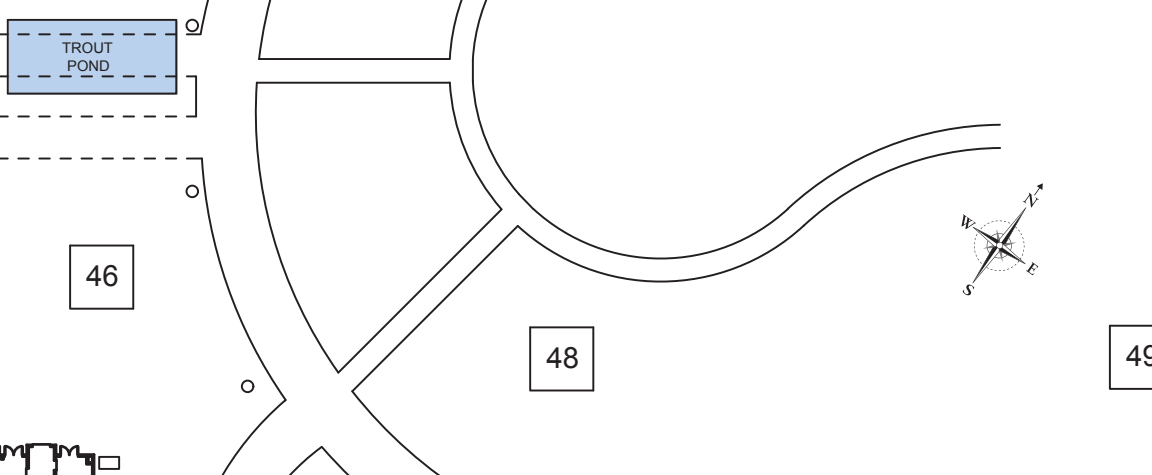

49

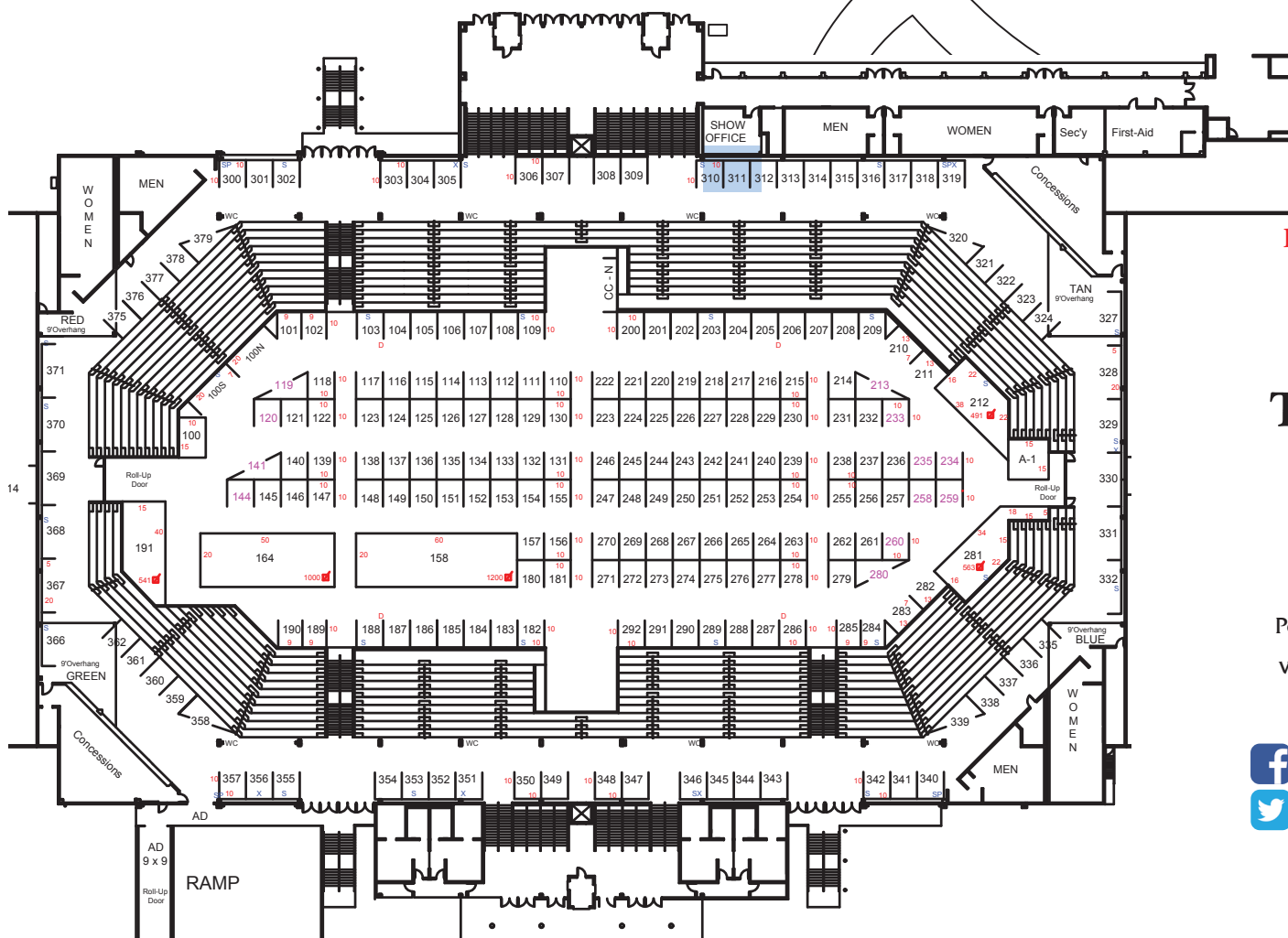

Red Booth Numbers Mean Last In, First Out

For more information, contact
O'LOUGHLIN TRADE SHOWS®

503-246-8291
800-343-6973 U.S. ONLY
Fax 503-246-1066

P.O. Box 80750
Portland, OR 97280-1750 U.S.A.

website: thesportshows.com
email: info@otshows.com

fb.com/thesportshows
 #thesportshows